

A-Tach # 20052



Designed for: Chevrolet Colorado 2023 - 20

A-Tach

Mobile Device Mounts

NOTICE: A-Tach Mounts will not be responsible for any damage to the vehicle due to the installation and/or use of the product. The product has been tested to fit securely to the listed vehicles. Instructions are provided for your convenience. You are responsible for the use of the product and to determine if you have the skill to attach the product without causing damage to your vehicle or the product.

Read all instructions and view the photos before attaching this product.

WARNING: Please hold the vehicle mount and holster over the place where the solution attaches to the dash BEFORE securely attaching it to the vehicle. This will insure you like the fit and location of the solution.



(1) The holster comes with a two part securing strap for the hand gun. Place your hand gun into the holster. Then snap the two parts of the strap together and place the strap in a position that will secure the hand gun into the holster.



(2) Slide the hooked parts of the Velcro on the strap into the slots on the sides of the holster. Using the included blue card stock will help. The strap is adjustable by the distance the straps are inserted into the slots. Be sure to align the hooked parts of the Velcro with the mesh parts to create a secure connection.



(3) Consider if you want the holster for right hand use or left hand use. Gently open the lower holster hook and insert the lower edge of the holster under the hook.



(3) Attach the side of the holster to the mount by inserting the steel clip arm on the mount through the clip slot on the side of the holster.

See additional instructions on the back side.

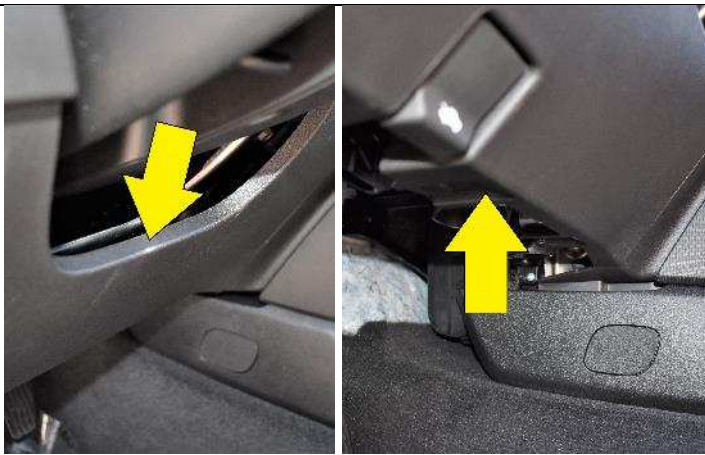

(4) Inspect the area the SAMS will attach to ensure it will not be an obstruction. Clean the area where the mount will attach. The top of the mount will attach onto the opening the top of the panel below the steering wheel and the bottom will attach onto the lower edge of the panel illustrated with the arrow in the photo.



(5) Remove the covering from the tape. Hook the top edge of the SAMS into the top of the panel under the steering wheel. (See Photo) The mount should attach **all the way only the right** side of the top panel edge. If it is too far to the left, the lower edge will not attach.



(4) Press down on the mount and, at the same time



(5) Press forward on the mount to hook the mount onto the low edge of the panel. The tape will not leave any residue if the mount is removed.

A-Tach Mounts Limited Warranty

A-Tach warrants the product to be free of all defects in materials and workmanship for a period of six (6) months from the date of purchase. This warranty extends to the original buyer. Damaged products caused by anything outside of shipping damage are not covered by this warranty.

Within the period of this warranty, A-Tach has the option to repair or replace the item or refund the purchase price. Any replacement parts will be done on an exchange basis. All repairs and service must be done by A-Tach. Product must be delivered to A-Tach during the warranty time along with proof of purchase price and date. The shipping and packaging costs will be the buyer's responsibility. Labor costs and parts to repair will be A-Tach Mounts responsibility.

A-Tach Mounts will not be responsible for any damage to the vehicle or product due to the installation and/or use of the product. A-Tach is not responsible for damages caused by extreme heat conditions. Any above exclusion may not apply in states that do not allow the exclusion or limitation. This warranty gives you specific legal rights. You also may have other rights which vary from state to state.

Returns

Before any product may be returned, A-Tach must give prior approval. An RMA# (Return Merchandise Authorization Number) needs to be given to the buyer to return a product. All returns must be within (30) days of the invoice date and include proof of purchase. Any returned product must be undamaged and in like new condition. Returned product must be scratch free with no additional holes or screw marks on the product.

A-Tach reserves the right to withhold any refund if the product is believed to be damaged. A return must include a copy of the original order or invoice. All parts and components that were shipped with the original product must be included with the returned product.

Contact Information: A-Tach Mounts / Clarkston, WA 99403 / cs@attachmounts.com